

K664GA

Spare parts

Ersatzteile

Pièces détachées

Reserve onderdelen

Repuestos

Reservdelar

ACTUAL PARTS
 MAY NOT APPEAR
 AS SHOWN

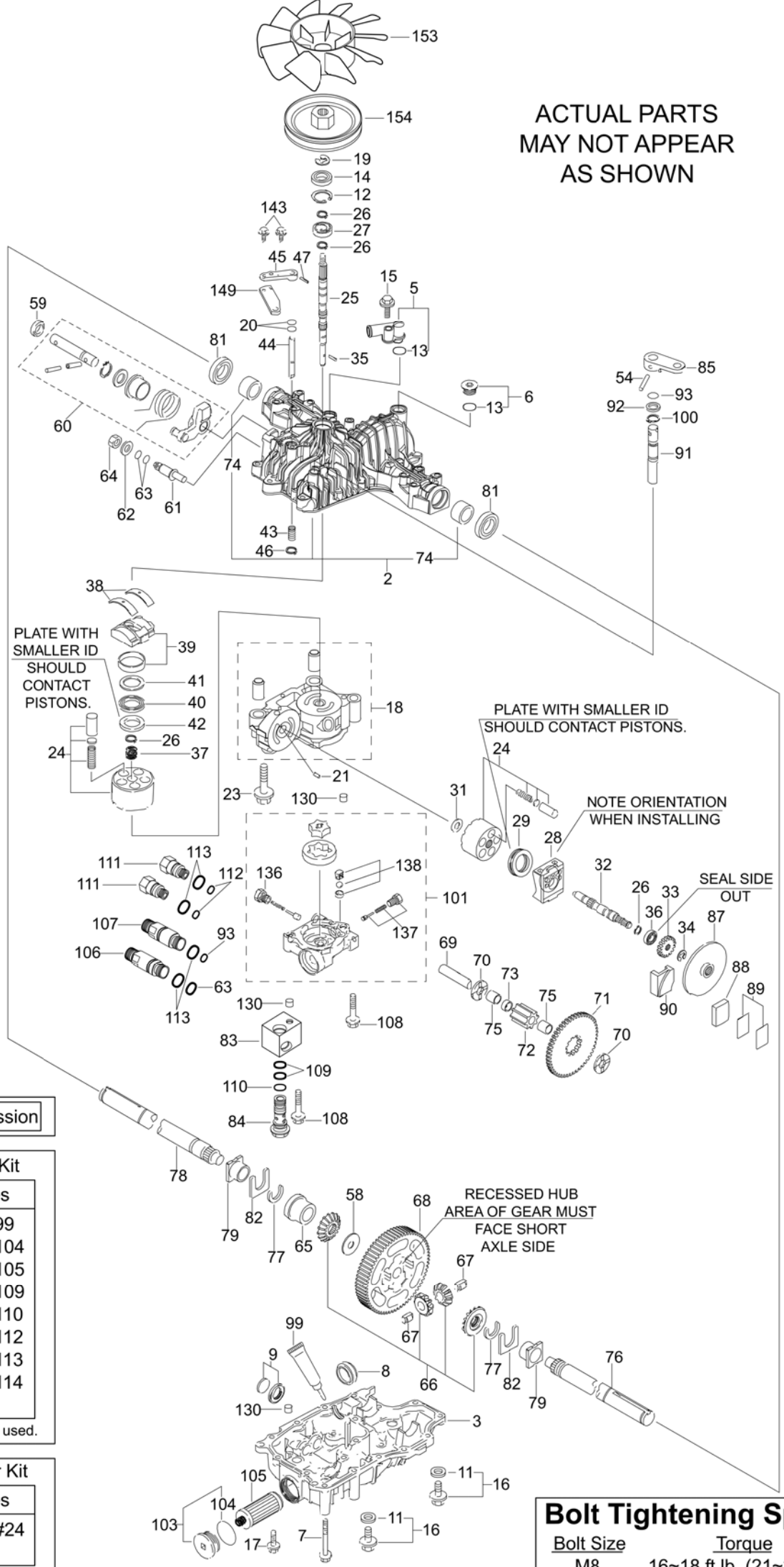

PLATE WITH SMALLER ID SHOULD CONTACT PISTONS.

PLATE WITH SMALLER ID SHOULD CONTACT PISTONS.

NOTE ORIENTATION WHEN INSTALLING

SEAL SIDE OUT

RECESSED HUB AREA OF GEAR MUST FACE SHORT AXLE SIDE

1 K664GA Transmission

200

K664GA Seal Kit	
Kit Includes	
#8	#99
#11	#104
#13	#105
#14	#109
#20	#110
#59	#112
#63	#113
#81	#114
#93	

All parts may not be used.

201

K664GA Repair Kit	
Kit Includes	
#18	(2) #24
#200	- Seal Kit

All parts may not be used.

Bolt Tightening Specs.	
Bolt Size	Torque
M8	16~18 ft.lb. (21~24 N.m)
M10	33~47 ft.lb. (45~64 N.m)

(K664GA-HUSQVARNA / 787Q0584560)

HUSQVARNA AB (52333)

ID Number	Service Part	Part Description	TTC Part No.
1		K664GA TRANSAXLE	787Q0584560
2	523 07 44-01	UPPER CASE KIT	1A632024121
3	574 51 44-01	LOWER CASE	187Q0524190
5	574 51 46-01	FITTING KIT	1A632084740
6	574 51 47-01	OIL CAP KIT	187Q0599040
7	535 41 46-83	CAP SCREW 8 * 75	19215424310
8	535 41 46-23	FILTER	1A632024320
9	535 41 46-94	MAGNET CMP	19216324350
11	535 40 28-25	WASHER SEAL 10	22190100000
12	535 40 28-50	SNAP RING C 35	22252000350
13	535 40 28-22	O-RING P18	24311000180
14	506 95 72-01	SEAL TC 153507	24421153507
15	502 46 28-01	BOLT 8 * 35	26106080352
16	523 07 47-01	DRAIN BOLT KIT	1A632099320
17	535 40 28-28	TAPPING SCREW 8 * 30	26476080302
18	574 51 48-01	CENTER CASE AD	187Q0524950
19	535 40 28-07	E-RING 15	19215485310
20	535 40 28-15	O-RING 1A P10A	24311240100
21	535 40 28-58	PIN 3 * 9.8	19216824760
23	535 41 47-09	BOLT 10 * 65	26106100652
24	505 34 86-01	CYLINDER BLOCK KIT	1A632025500
25	523 07 49-01	PUMP SHAFT	1A632025301
26	535 40 28-81	SNAP RING S15	19215425310
27	535 40 28-71	BEARING 6202C3	24101062020
28	535 41 46-22	MOTOR HOUSING	1A632024210
29	502 44 92-01	BEARING THS060513	1A632024240
31	535 40 28-79	WASHER 12 * 24 * 1	19216825230
32	535 41 46-28	MOTOR SHAFT	1A632025270
33	535 41 46-67	MOTOR GEAR 14T	1A632085400
34	535 41 46-29	E-RING	1A632025350
35	535 41 46-92	PIN 3 * 13.8	19215488330
36	535 41 47-04	BEARING 6302DUC3	24102063020
37	535 41 46-85	PUMP SPRING	19215425200
38	574 51 58-01	THRUST METAL	17808006200
39	574 51 59-01	SWASH PLATE	187Q0527100
40	574 51 60-01	BEARING K81106	17808006100
41	577 34 21-01	THRUST PLATE A	17808006110
42	535 41 46-89	THRUST PLATE B	19215427210
43	502 46 01-01	SPRING 25	19215427281
44	535 41 46-34	BYPASS SHAFT	1A632029510
45	535 40 28-17	BYPASS LEVER	1A632029520
46	535 40 28-49	SNAP RING 10	19216829570
47	535 40 28-16	SPRING PIN 3.0A * 20	22351030020
54	535 41 49-22	ROLL PIN 6 * 40	22351060040
58	502 45 12-01	WASHER 17 * 36 * 6.4	1A632096110
59	535 40 28-11	SEAL TC 162606	19406527270
60	523 07 66-01	CONTROL SHAFT KIT	1A632029801
61	535 40 28-92	FULCRUM	1A632029700

(K664GA-HUSQVARNA / 787Q0584560)

HUSQVARNA AB (52333)

ID Number	Service Part	Part Description	TTC Part No.
62	535 40 28-13	WASHER 12	22137120000
63	535 40 28-14	O-RING 1A P14	24311000140
64	506 95 66-01	NUT 12	26776120002
65	535 41 46-44	COLLAR 25.4	1A632034270
66	502 44 98-01	DIFFERENTIAL GEAR KIT	1A632081520
67	535 41 46-56	DIFFERENTIAL PINION PIN	1A632081810
68	523 07 68-01	FINAL GEAR	1A632099060
69	535 41 46-39	FINAL SHAFT P	1A632033410
70	535 41 46-40	WASHER 15 * 35 * 3.2	1A632033420
71	535 41 46-59	REDUCTION GEAR 51T	1A632083470
72	535 41 46-62	FINAL PINION GEAR 11T	1A632083550
73	535 41 46-58	COLLAR	1A632083430
74	535 41 46-90	BUSHING 25.4	19215434240
75	535 41 46-57	NEEDLE BEARING 151814	1A632083420
76	577 34 37-01	AXLE SHAFT LEFT	187Q0534120
77	535 41 46-96	RETAINING RING 23	19216734160
78	577 34 39-01	ALE SHAFT RIGHT	187Q0534110
79	535 41 46-97	BUSHING 25.4	19216734240
81	535 40 28-10	SEAL S 25.4 * 42 * 8	19215434270
82	535 41 46-45	THRUST WASHER	1A632034290
83	577 34 40-01	PIPING BLOCK	187Q0524721
84	577 34 41-01	CONNECTOR	187Q0524710
85	535 40 28-08	BRAKE LEVER	1A632089870
86	574 51 50-01	BRAKE RETURN SPRING	1A632089900
87	535 41 46-46	BRAKE DISC	1A632036110
88	535 41 46-47	BRAKE SHOE	1A632036120
89	502 44 95-01	SHIM KIT	1A632036170
90	535 41 46-52	BRAKE ACTUATOR	1A632036201
91	535 41 46-50	BRAKE SHAFT	1A632036160
92	535 41 46-51	WASHER 16 * 23 * 1.6	1A632036190
93	535 41 46-19	O-RING 1A P12	24311000120
99	505 34 87-01	SEALANT	1A646099500
100	535 41 47-02	SNAP RING	22242000160
101	535 46 65-01	PUMP CASE KIT	1A632096150
103	574 51 51-01	CAP KIT	1A637094450
104	574 51 52-01	O-RING 1A 2040	24351240400
104	574 51 52-01	O-RING 1A 24040	24351240400
105	535 40 28-19	FILTER	1A632026450
106	574 51 53-01	PIPING A 3/8	187Q0524740
107	574 51 54-01	PIPING B 3/8	187Q0524750
108	535 41 47-06	BOLT 8 * 45	26106080452
109	574 51 55-01	PACKING P12A	24315000120
110	574 51 56-01	PACKING P16A	24315000160
111	577 34 43-01	CONNECTOR	187Q0526430
112	535 46 65-03	O-RING 6.1	19485049290
113	502 46 20-01	O-RING 1A P16	24311000160
130	535 41 49-05	ALIGNMENT SLEEVE 11 * 7	19452141570
136	502 46 06-01	CHARGE RELIEF VALVE	19216726300

(K664GA-HUSQVARNA / 787Q0584560)

HUSQVARNA AB (52333)

ID Number	Service Part	Part Description	TTC Part No.
137	535 46 65-05	IMPLEMENT RELIEF VALVE	19216726250
138	502 45 15-01	3RD CHECK VALVE	1A637026350
143	535 40 28-27	BOLT 6 * 14	26013060142
149	535 40 28-26	BYPASS ARM	1A632089521
153	502 45 03-01	FAN	1A632085100
154	502 45 05-01	INPUT SHEAVE	1A632085120
200	574 21 49-01	SEAL KIT	187Q0599010
201	574 21 78-01	REPAIR KIT (K664G)	187Q0599120